

MODEL K75

DAMPER INSTALLATION INSTRUCTIONS WITH TRANSFER OPENINGS & DUCT TERMINALS FOR 1-1/2 & 3 HOURS CURTAIN FIRE DAMPERS TYPE A & LA

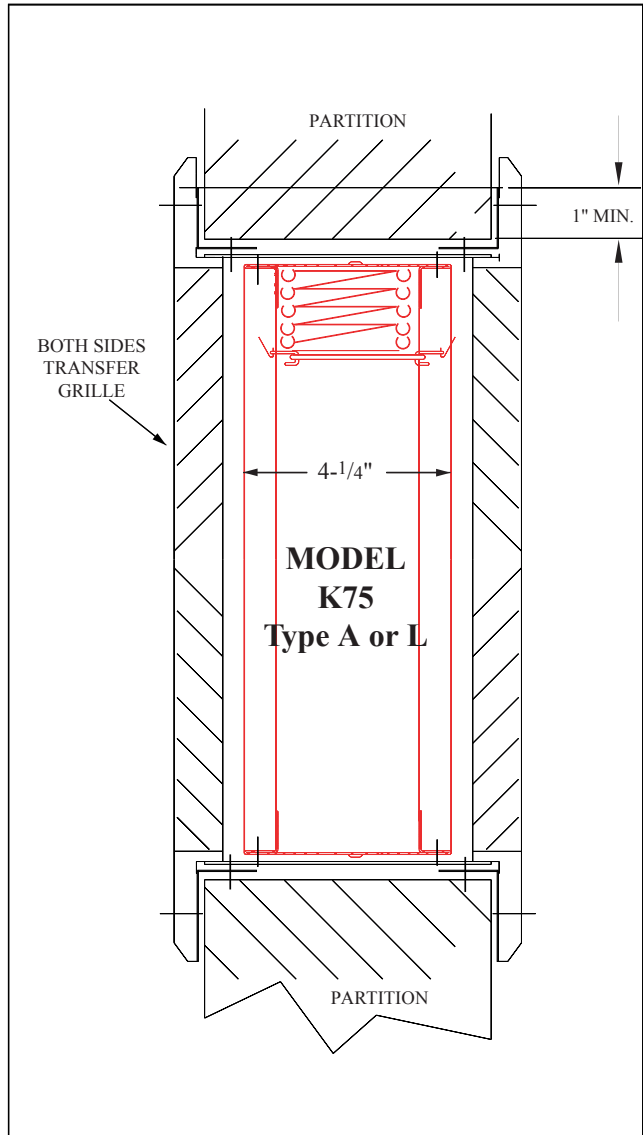
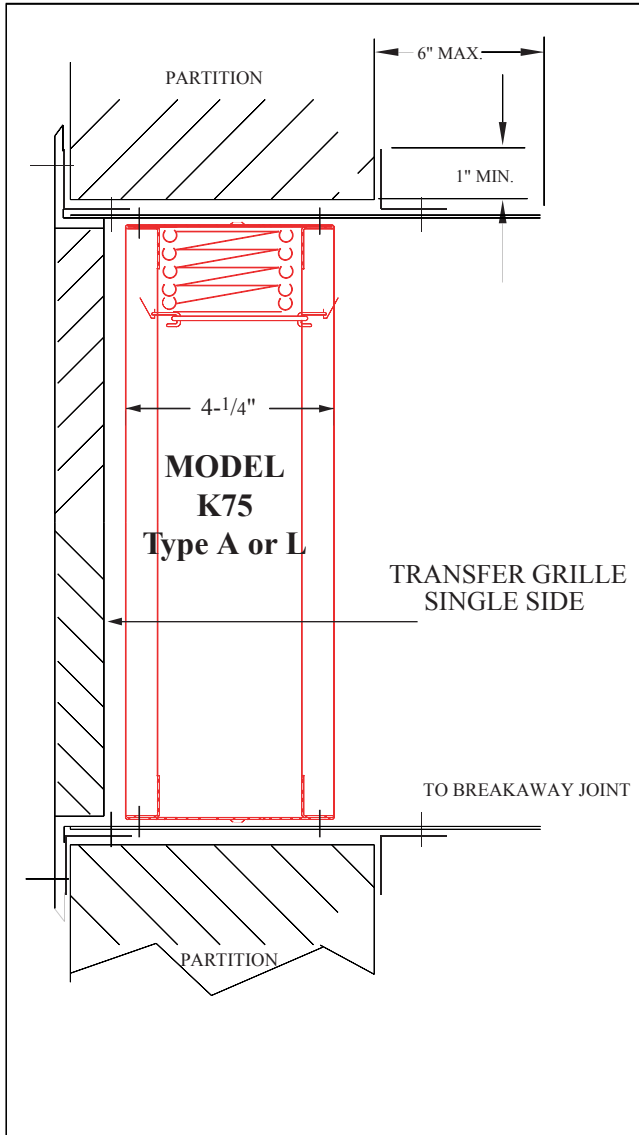

1- Perimeter mounting angles to be a minimum of 1 1/2x1 1/2 x16 Ga on dampers 36" x 50" and smaller. For dampers greater than 36" x 50", angles to be a minimum of 1 1/2 x 1 1/2 x 14 Ga.

2- Grille to flange fasteners cannot penetrate the fire wall.

3- Secure angles to sleeve only, so as to frame the wall opening. Fasten to the sleeve only using the same means as required for fastening the damper to the sleeve.

4- Grille to flange attachment by means of 1/4" dia. pop rivets, #8 sheet metal screws or #8 bolts and nuts. Fasteners to be plated steel or stainless steel, minimum two fasteners per side.

